

版本 Edition	变更内容 Description of the change
D	电感数据更新

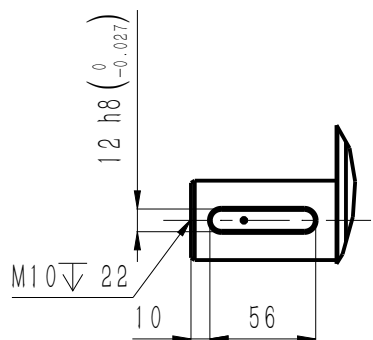

标配: A型圆头普通平键  
A12X8X56(GB/T1096)

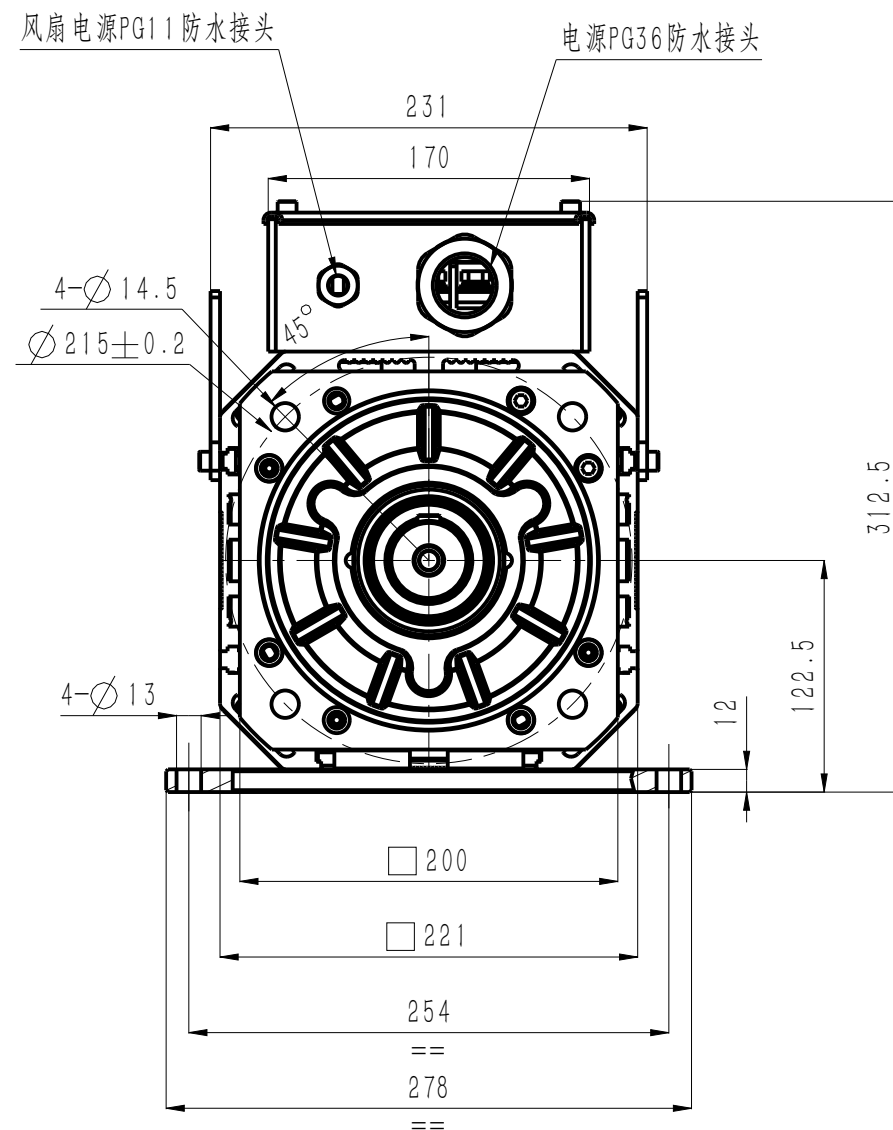
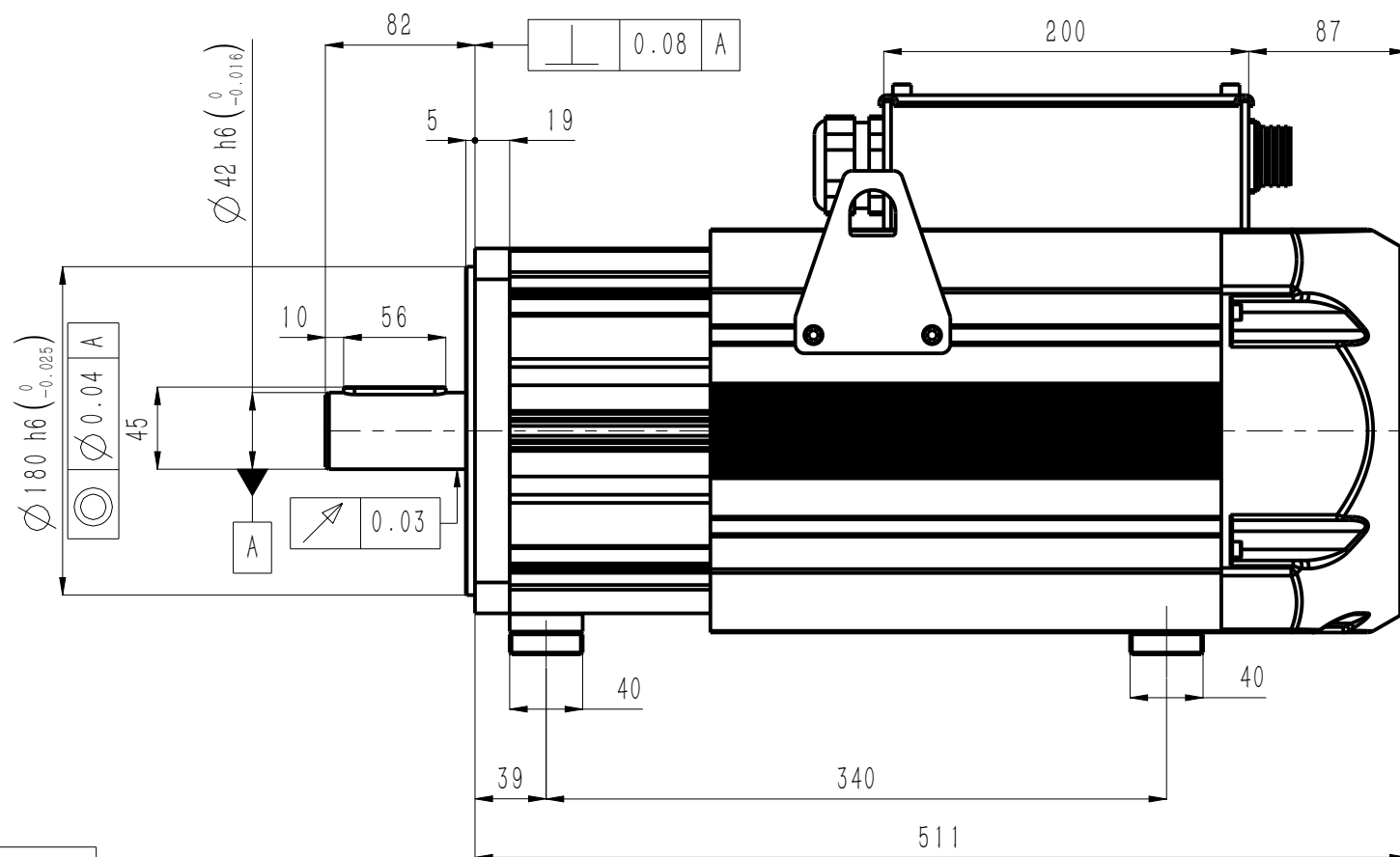

## 电机技术参数 Motor parameters

额定电压 Rated voltage	380	V AC
额定功率 Rated power	25.2	kW
额定扭矩 Rated torque	142	N·m
额定电流 Rated current	46.7	Arms
峰值扭矩(850rpm) Peak torque	354	N·m
峰值电流(850rpm) Peak current	96.8	Arms
峰值扭矩(1700rpm) Peak torque	284	N·m
峰值电流(1700rpm) Peak current	96.2	Arms
峰值扭矩(2700rpm) Peak torque	172	N·m
峰值电流(2700rpm) Peak current	95.2	Arms
额定转速 Rated speed	1700	rpm
峰值转速 Maximum speed	2700	rpm
扭矩系数 Torque constant	3.04	N·m/Arms
反电势常数 Back EMF constant	243.3	V/krpm
线电阻 line resistance	0.31	Ω
线电感 line inductance	7.7	mH
转动惯量 Moment of inertia	177±10%	kg·cm <sup>2</sup>
轴向允许载荷 Axial allowable load	/	N
径向允许载荷 Radial allowable load	/	N
极对数 Number of pole pairs	4	对

## 引线定义

### Wiring definition

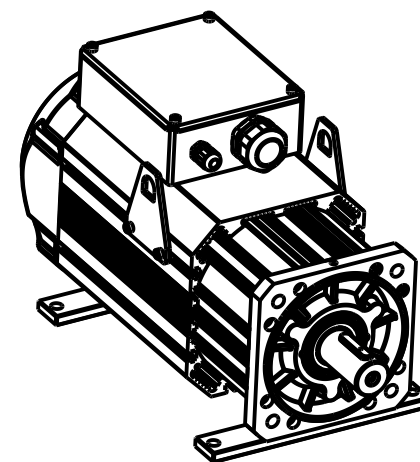
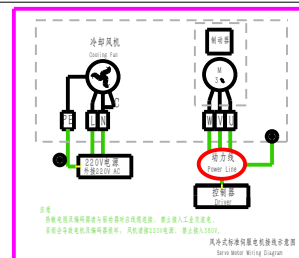
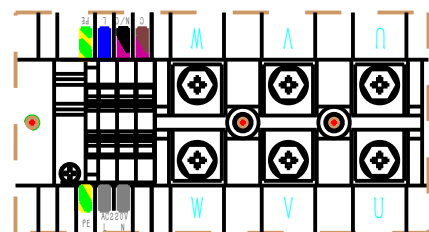

Speed-torque characteristic curve

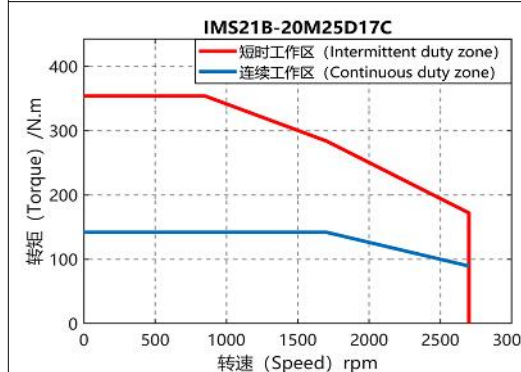

IP 防护等级 Ingress Protection Rating	IP54	<div>信号航插规格 Encoder connector</div> <div>YD28J15Z</div> <div></div>	<div>编码器规格 Connector specifications</div> <div>23-bit optical encoder</div> <div>12-bit Resolver encoder</div>	<div>引线定义 Wiring definition</div> <table><tr><td>1</td><td>2</td><td>3</td><td>4</td><td>5</td><td>6</td><td>7</td><td>8</td><td>9</td></tr><tr><td>PE (屏蔽)</td><td>SD+ (蓝)</td><td>SD- (黄)</td><td>+5V (红)</td><td>0V (黑)</td><td>BAT+ (棕)</td><td>BAT- (白)</td><td>KTY84-130+ (黄)</td><td>KTY84-130- (绿)</td></tr><tr><td>PE (屏蔽)</td><td>Ref+ (红白)</td><td>Ref- (黄白)</td><td>Cos- (黑)</td><td>Cos+ (红)</td><td>Sin+ (黄)</td><td>Sin- (蓝)</td><td>KTY84-130+ (黄)</td><td>KTY84-130- (绿)</td></tr></table>									1	2	3	4	5	6	7	8	9	PE (屏蔽)	SD+ (蓝)	SD- (黄)	+5V (红)	0V (黑)	BAT+ (棕)	BAT- (白)	KTY84-130+ (黄)	KTY84-130- (绿)	PE (屏蔽)	Ref+ (红白)	Ref- (黄白)	Cos- (黑)	Cos+ (红)	Sin+ (黄)	Sin- (蓝)	KTY84-130+ (黄)	KTY84-130- (绿)
1	2			3	4	5	6	7	8	9																													
PE (屏蔽)	SD+ (蓝)			SD- (黄)	+5V (红)	0V (黑)	BAT+ (棕)	BAT- (白)	KTY84-130+ (黄)	KTY84-130- (绿)																													
PE (屏蔽)	Ref+ (红白)			Ref- (黄白)	Cos- (黑)	Cos+ (红)	Sin+ (黄)	Sin- (蓝)	KTY84-130+ (黄)	KTY84-130- (绿)																													
绝缘等级 Insulation class	F																																						
绝缘电阻 Insulation resistance	>100MΩ DC500V																																						
电机重量 Motor weight	67.7 kg																																						
工作温度 Operating temperature	-20℃~40℃																																						
工作湿度 Operating humidity	20%~80% (不结露 Non-dewfall)																																						
推荐安装海拔 Recommend installing altitude	<1000m(1km以上降额使用) (Derate for use above 1km)																																						

SN	料号 P/N	整机型号 Model and Specification		编码器 Encoder	
	11101-01710	IMS21B-20M25D17C-4-R7F-A		12位旋变	
	11101-01734	IMS21B-20M25D17C-4-P9F-A		23位多圈光编	
<div> <div> <div></div> <div></div> <div></div> </div> <div> <div></div> <div></div> <div></div> </div> <div> <div></div> <div></div> <div></div> </div> </div> <div> <div>深圳市英威腾电气股份有限公司</div> <div>Shenzhen INVT Electric Co., Ltd.</div> </div>					
D	替换	/	26-3-19	名 称	电机外形图 Motor outline dimension drawing
版 本	更改方式	更改人	日期		
设 计	/			料 号	材 质
校 核	/				
工 艺	/			图 号	投影标识
审 核	/				
标准化	/			重 量	比 例
批 准	/				
<div> <div> <div></div> <div></div> <div></div> </div> <div> <div></div> <div></div> <div></div> </div> <div> <div></div> <div></div> <div></div> </div> </div> <div> <div>第 1 页</div> <div>共 1 页</div> </div>					